



9900R Cleaning Procedure

Dirty sensors can cause false errors such as Double and Half errors, and may decrease the performance of the Cassida 9900R. It is suggested that the user performs daily maintenance on the unit to maintain top performance.

The unit should always be turned off and disconnected from its power cord before cleaning. DO NOT use solvents such as thinner, alcohol, etc. to clean the machine.

Most operational problems can be avoided by regular care and preventative maintenance. Taking regular care of the 9900R will significantly increase its lifetime.

For best results, it is recommended to use an air duster and a soft bristle brush to remove any dust or debris from the interior of the unit. When not using the machine for an extended period, cover it with the dust cover (not included with the unit) to prevent dust from settling inside.

All parts of the Cassida 9900R need daily care and cleaning. Pay close attention to the sensors, which are delicate components. If any dust or other foreign matter adheres to the sensors, it may cause various problems during operation of the machine.

- To avoid malfunction caused by foreign objects, please clean your machine every day.
- Clean inner sensors with the provided dry cloth frequently.
- Clean hopper and stacker sensors with the provided bristle brush or a dry cloth frequently.
- Rubber rollers may be cleaned with a slightly damp cloth. You may use a small amount of liquid soap on the cloth, but the soap residue should properly removed.

9900R Cleaning Procedure

Cassida 9900R Sensors

1. Hopper Sensor - One Sensor
2. Reject Pocket Sensors - Four Sensors
3. Stacker Sensors - Two Sensors

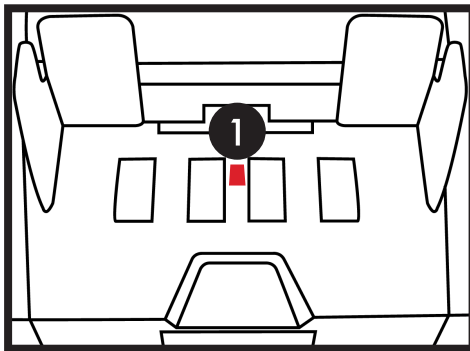

Figure 1: Hopper Sensor
(black circular sensor in center), located at top
of unit where bills are placed.

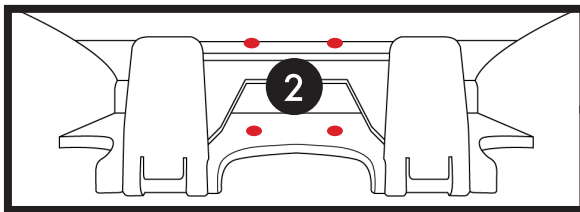

Figure 2: Reject Pocket Sensors.

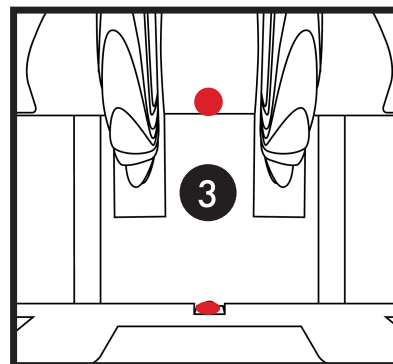
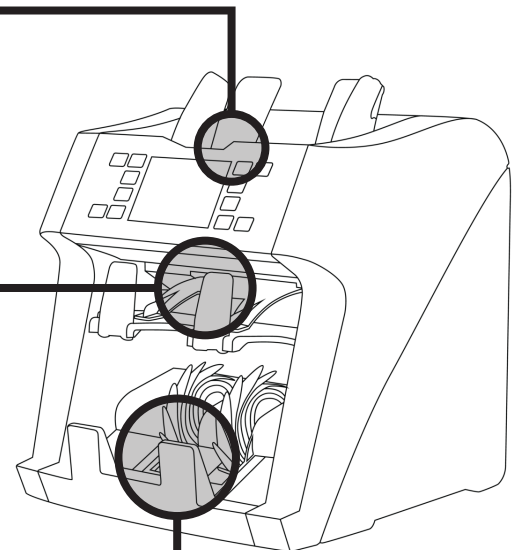

Figure 3: Stacker Sensors
(clear LED and black LED), located where
money is stacked after counting.



9900R Cleaning Procedure

Cassida 9900R Sensors (continued)

4. Contact Image Sensors (CIS) - Two Sensor Bars
5. Magnetic Sensor (MG) - Five Sensors

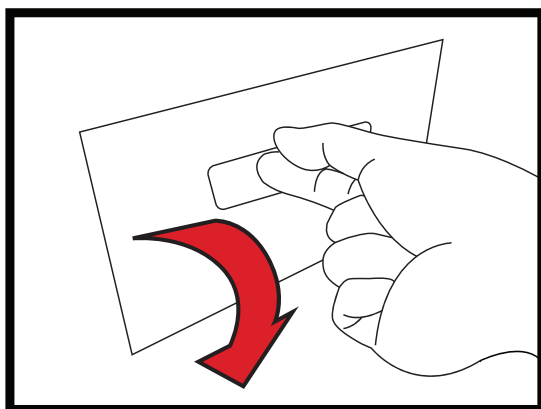

Figure 4: To open the back of the unit press up in the handle and pull down.

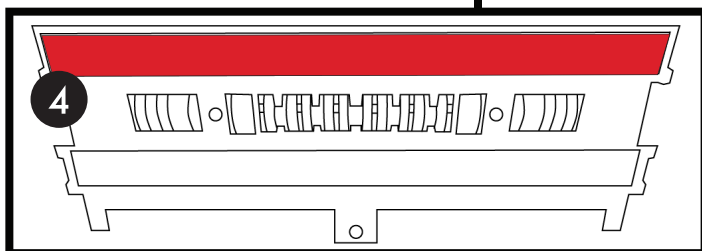
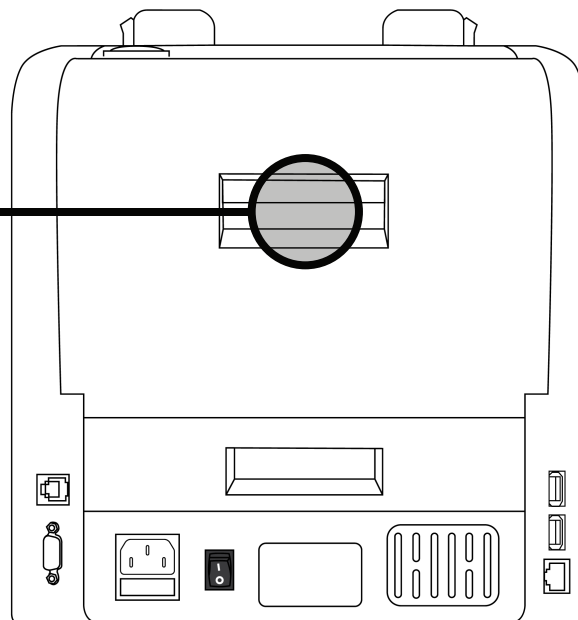

Figure 5: Upper sensors - One large CIS sensor bar.

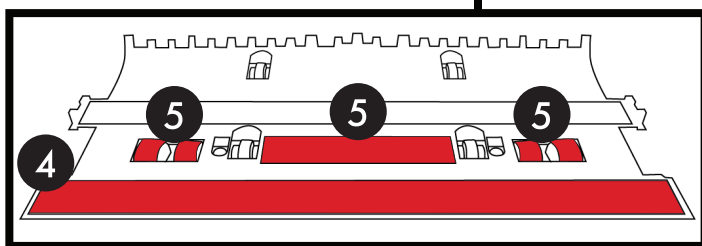

Figure 6: Lower sensors - Five MG sensors, and one large CIS sensor bar. (CIS sensor bar corresponds to upper sensor bar shown in Figure 5).

Cassida suggests that the user cleans the unit at least once per week. For heavy use locations and operations, the user may clean the unit daily to avoid heavy buildup that may cause improper operation. When the unit is not in use, Cassida suggests that the user covers the unit with a dust cover.

If, after cleaning all sensors, this does not resolve the issue, please see the support section on the Cassida USA website at www.cassidausa.com or contact Cassida Support at support@cassidausa.com for further troubleshooting.