

Quattro Cleaning Procedure

Standard maintenance and cleaning of the unit are important and recommended to significantly prolonging the lifespan of the product. Cleaning the unit helps prevent issues that may lead to costly repairs. Dirty sensors can affect the overall performance of the Cassida's Quattro, which can lead to a variety of errors like genuine bills being rejected. We at Cassida suggest performing weekly cleaning on the unit to maintain top performance.

TOOLS NEEDED

Air Duster



Cleaning Cotton Swab



NOTE:

To clean the unit, it's recommended to use Cassida cleaning products.

STEPS

We recommend the user follows the steps below to properly clean your Quattro.

1. Turn the power switch off and disconnect the power cord from the machine.
2. Open the lid slowly and carefully as shown below.

NOTE: The lid is held in by tabs, there is no release button.

3. Remove any foreign objects that may be in the bill path.

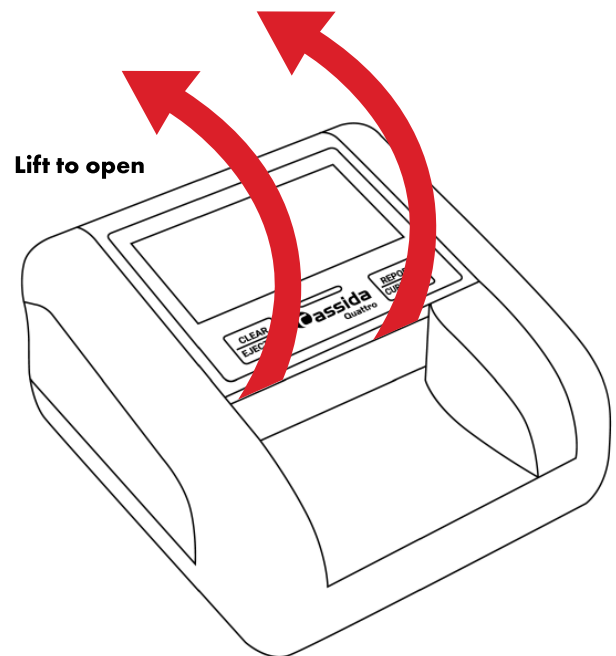

Quattro Cleaning Procedure

4. Gently wipe the sensors with a special cleaning cotton swab (or a microfiber cloth/cotton swab lightly moistened with isopropyl alcohol) as shown below.

NOTE: While cleaning the sensors, make sure to not move the three belts and ensure that they stay properly aligned.

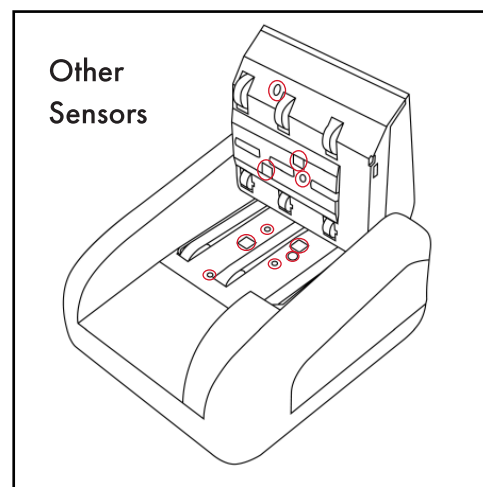
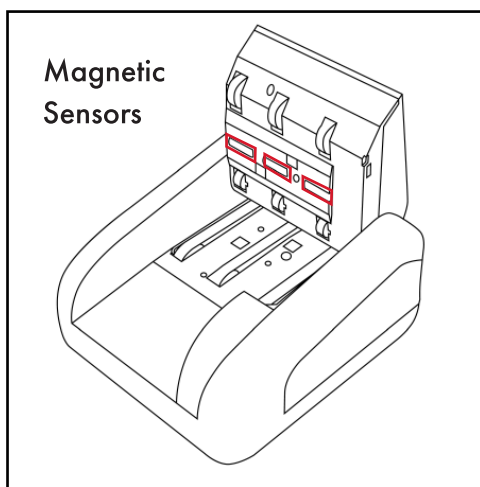

5. Clean the dust from the machine using an air duster. Spray the air duster in the following two areas as shown below. Start with the bottom of the lid.

NOTE: Be cautious and keep the nozzle 1-2 inches away from the unit all times.

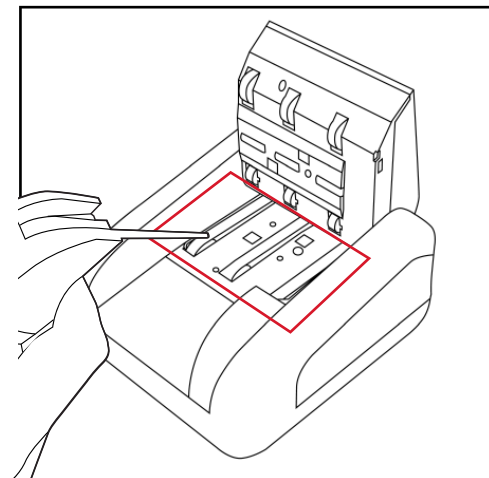
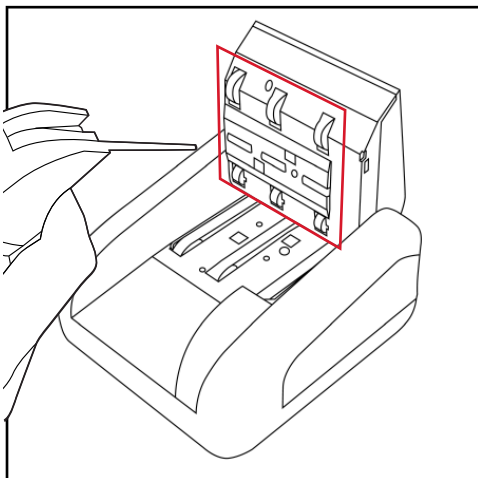

Quattro Cleaning Procedure

6. To avoid any issues once the unit has been cleaned, ensure that:

- a. The three feeding belts are aligned correctly
- b. The lid is closed properly (a soft click should be heard when closing the lid).
- c. The magnetic bill guide is in the proper position (pushed all the way to the right).

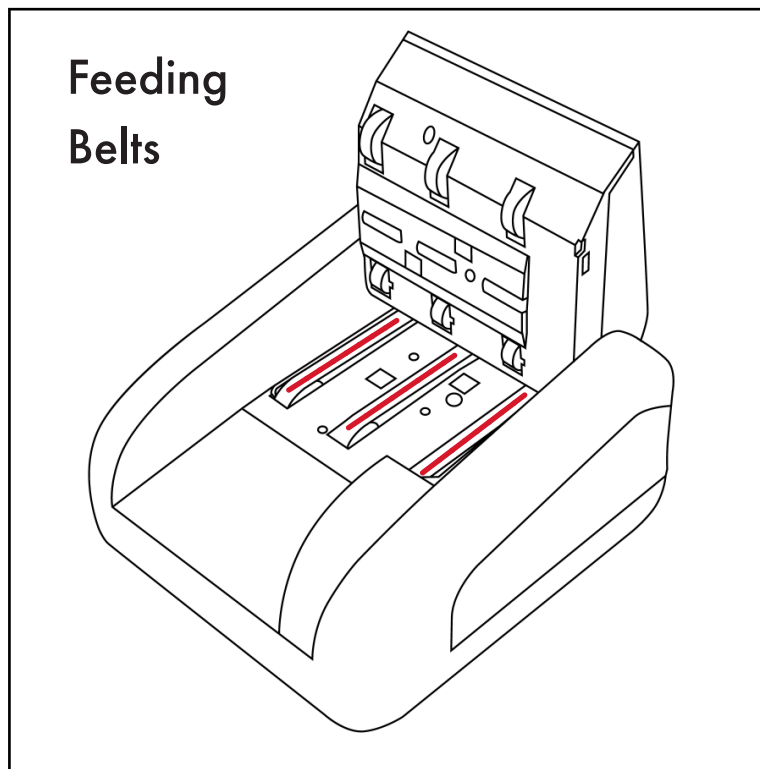

7. If, after cleaning the unit, issues are still occurring with the machine, please contact Cassida After Market Technical Services for further troubleshooting. Be sure to provide the following information:

- a. Model
- b. Serial Number (label with barcode, bottom of unit)
- c. Detailed description of symptoms

CONTACT INFORMATION

Cassida Corporation

After Market Technical Services

Support: <http://www.cassidausa.com/support>

E-Mail: support@cassidausa.com